

WINTER SOLSTICE 0900

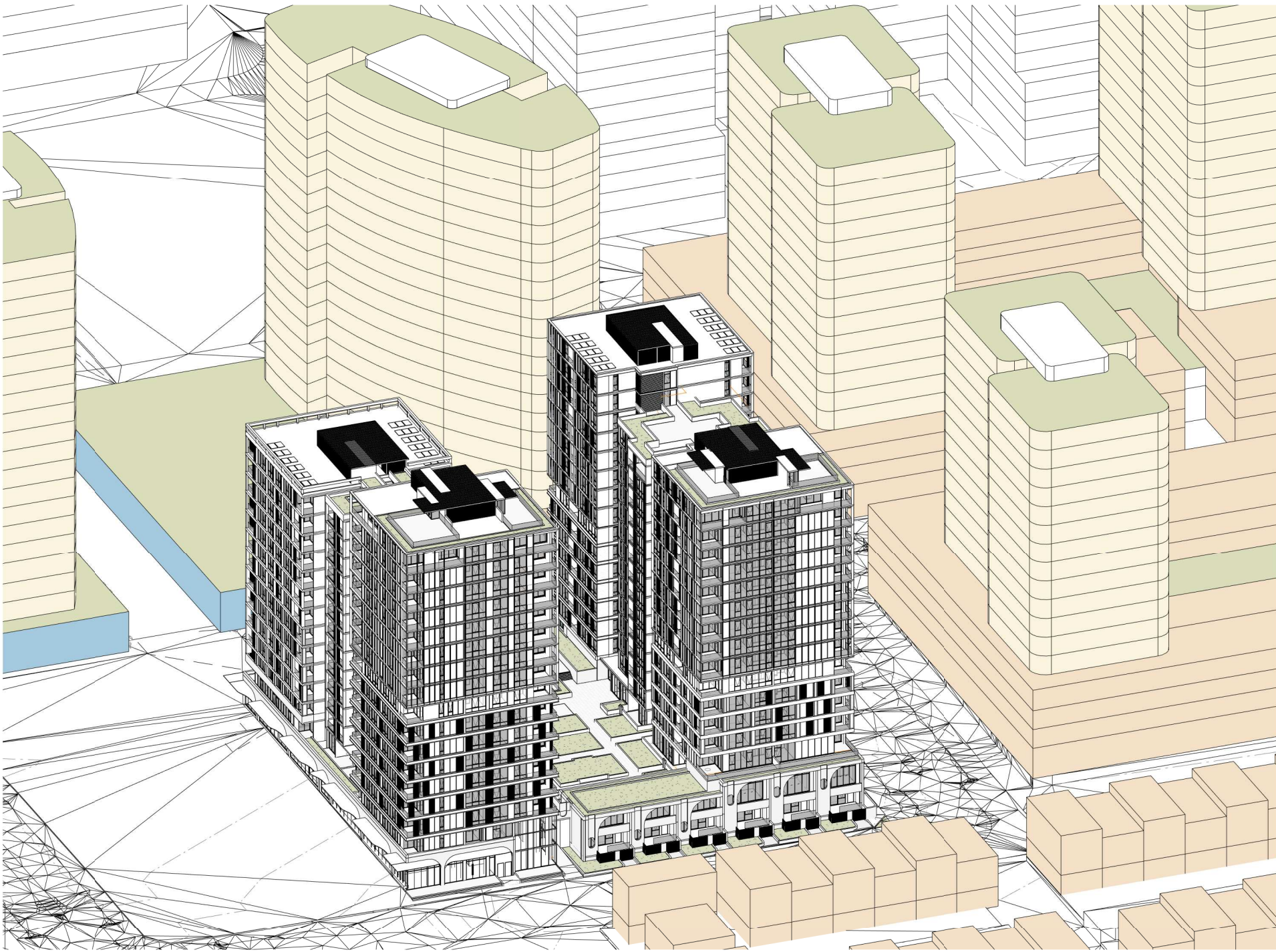

WINTER SOLSTICE 1000

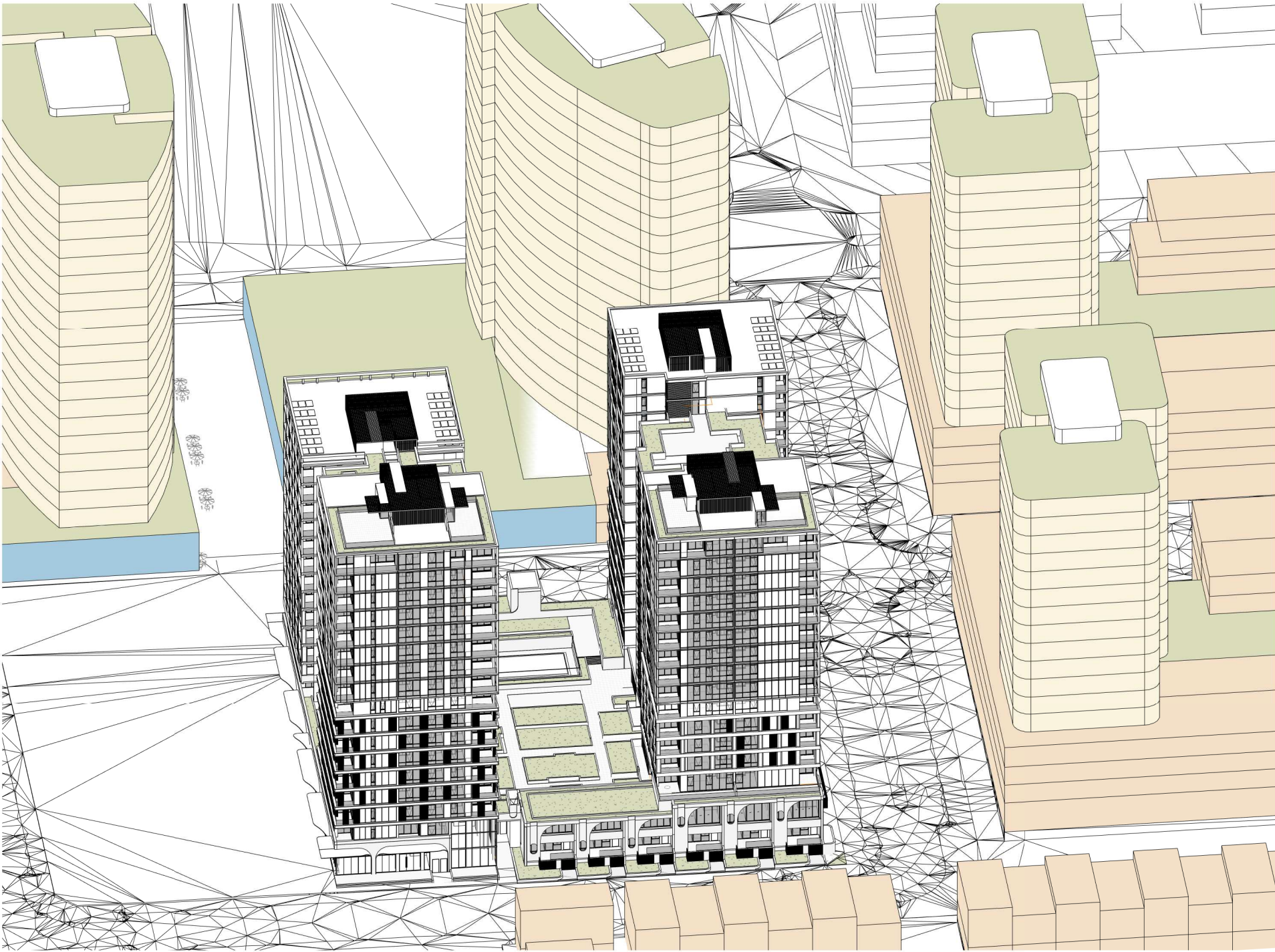

WINTER SOLSTICE 1100

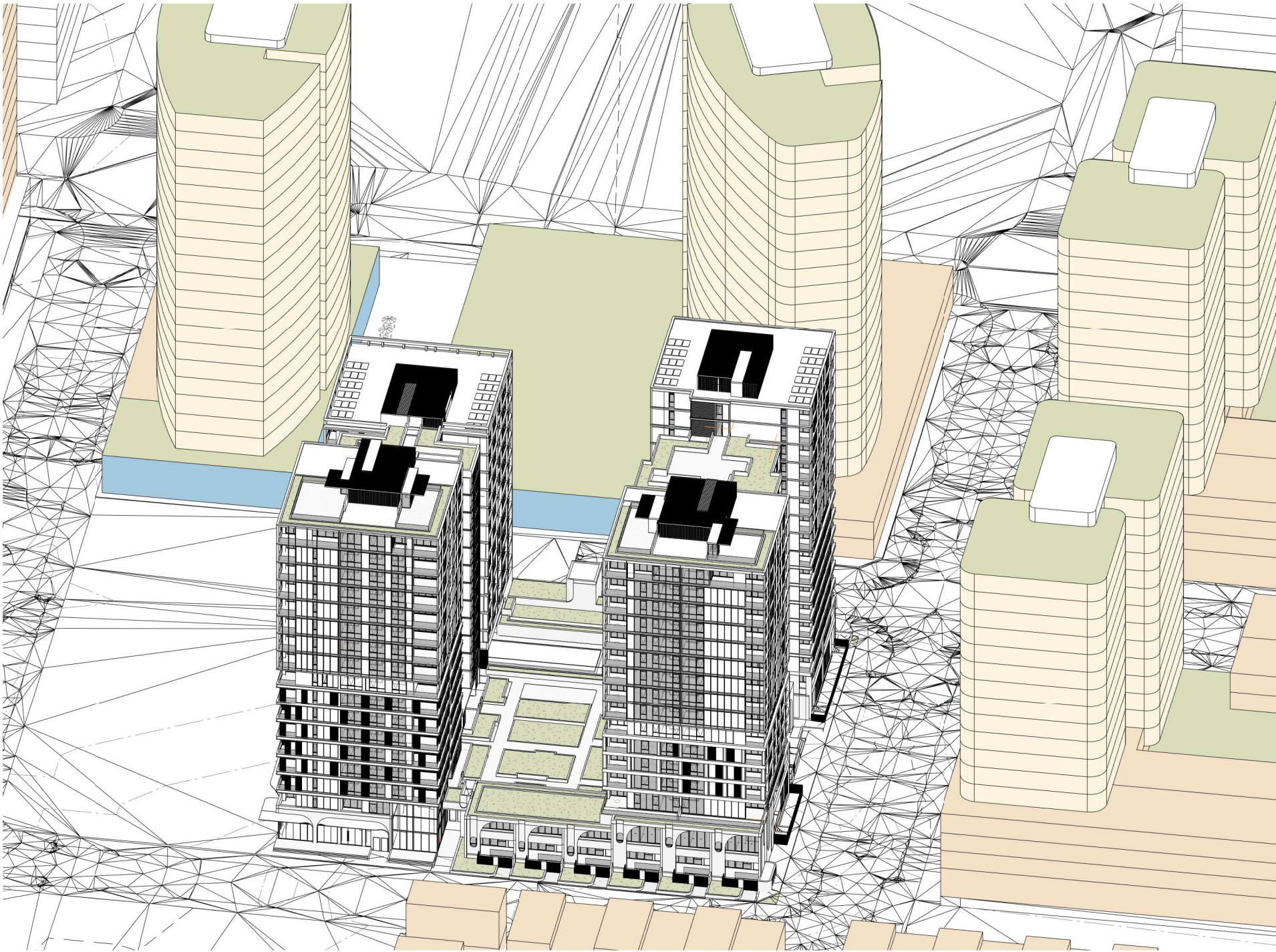

WINTER SOLSTICE 1200

In accepting and utilising this document the recipient agrees that SJB Architecture (NSW) Pty. Ltd. ACN 081 094 724 T/A SJB Architects, retain all common law, statutory law and other rights including copyright and intellectual property rights. The recipient agrees not to use this document for any purpose other than its intended use, to waive all claims against SJB Architects resulting from unauthorised changes, or to reuse the document on other projects without prior written consent from SJB Architects. Under no circumstances shall transfer of this document be deemed a sale. SJB Architects makes no warranties of fitness for any purpose. The Builder/Contractor shall verify job dimensions prior to any work commencing. Use figured dimensions only. Do not scale drawings.  
Nominated Architects: Adam Hadow-7188 | John Pradel-7004

Rev	Date	Revision	By	Chk.
11	2020.12.18	FOR COORDINATION	JG	NH
12	2020.12.22	DA ISSUE	JG	NH
25	2021.03.01	INTERNAL REVIEW	JG	NH
30	2021.03.09	DA ISSUE	JG	NH
31	2021.03.12	FOR INFORMATION	JG	NH
32	2021.03.18	DA ISSUE	JG	NH
34	2021.06.23	FOR COORDINATION	JG	NH
35	2021.06.24	PLACEHOLDER	JG	NH
37	2021.08.26	DA ISSUE	JG	NH

Client



Project

BATA PAGEWOOD - LOT E

Drawing Name

SOLAR POINT PERSPECTIVE

Date

2021.08.26

Scale

@ A1

Drawn

JG

Chk.

NH

Sheet Size

6354

Revision

DA-3005

Job No.

/ 37

**SJB Architects**  
L2, 490 Crown St  
Surry Hills NSW  
2010 Australia  
T 61 2 9380 9911  
www.sjb.com.au

